

Easy to Install No Frame Cutouts Needed

HES2S-140-A125

《 No mortising on the frame side. 》

《 Useful on frames that are too thin to mortise. 》

《 Compact body with high load capacity. 》



Black



Dark grey



Light grey

LAMP® NEW HES2S-140-A125

Load Capacity
50kgf/2pcs 65kgf/3pcs

3D Adjustability
Vertical: ±3mm Horizontal: +1mm
Depth: ±3mm

Easy to Install
No mortising is required
on the frame side.

■ Can be used on slim-framed and frameless doors because no frame mortising is required.

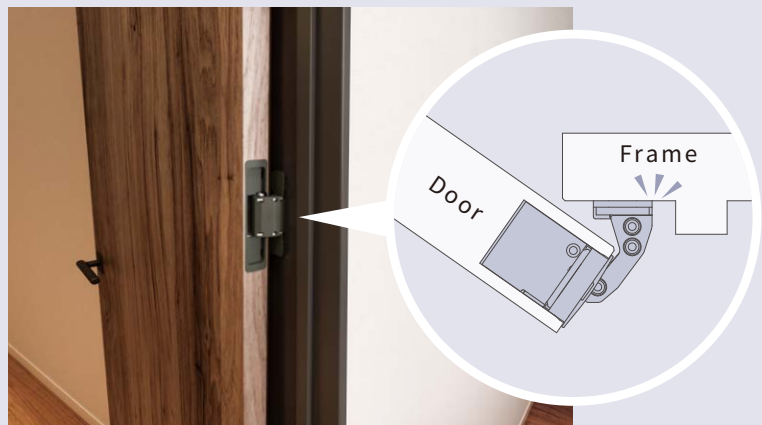

3-WAY ADJUSTABLE CONCEALED HINGE HES2S-140-A125 125° Opening



Passed 300,000 open/close private cycle test

- Surface mount for door frame enables easy installation.
- 3-way adjustment function allows vertical, horizontal, and depth adjustment after hinge installed.



Black Dark Grey Light Grey



Closed Back With cover and plate removed

[Remarks]

- Use with a door stopper, etc. to prevent opening farther than 125°.
- The hinge cannot be divided between the door and frame.

[Parts included]

- Countersunk head tapping screw 4x20 (8 pcs/hinge) Steel
- Door side drilling/frame side mounting template

[Locus Chart]

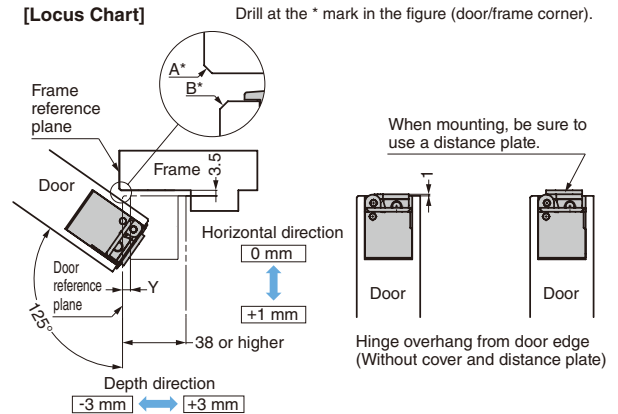

Y: Door Machining Margin	B: Door chamfering	A: Frame chamfering
4 or below	1 or higher	1 or higher
5		

[Usage Image]

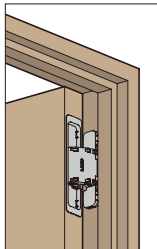

With front screws not requiring frame side drilling, installation is simple.

[Opened to 90° (without cover)]

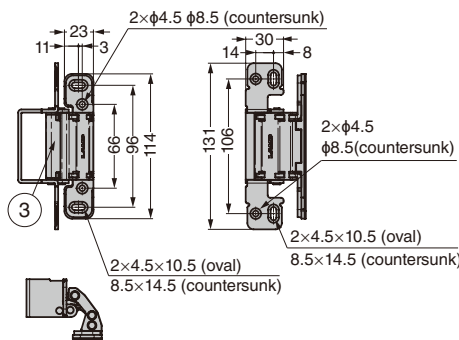

[Cut Out Dimensions]

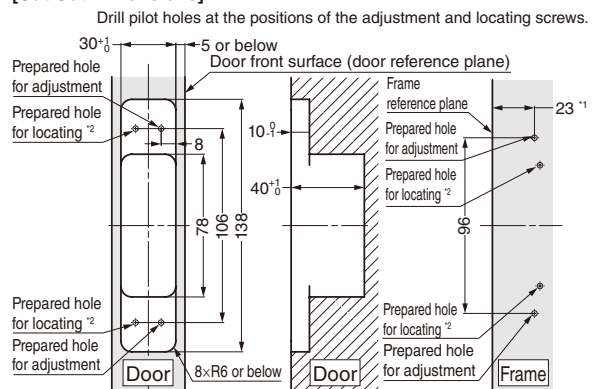

*1 When door machining margin is 5 mm.

*2 The position of prepared hole for locating changes according to adjustment.

[Opened to 125° (with cover)]

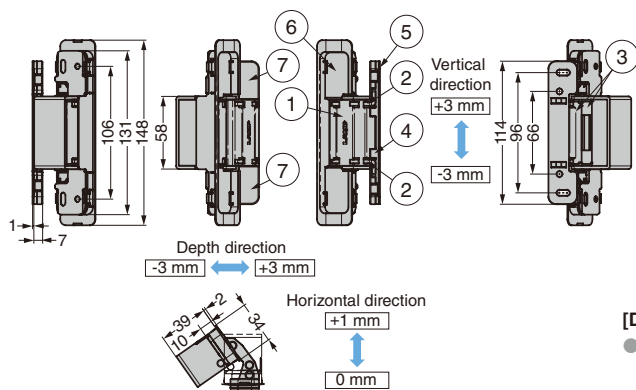

[Door Position Adjustment]

- Vertical adjustment (±3 mm)
- Horizontal adjustment (+1 mm)
- Depth adjustment (±3 mm)

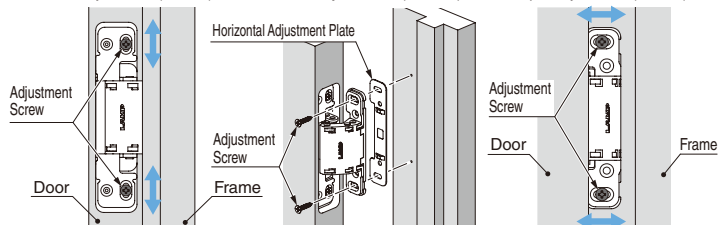

Adjust in the vertical/depth directions with oval hole screws and in the horizontal direction with the plate.

No.	Part Name	Material	Finish / Colour
①	Body	POM	Dark Grey, Light Grey, Black
②	Base Plate	SPCC	Nickel
③	Arm	Zinc Alloy (ZDC)	Chemical Treatment
④	Distance Plate	PBT	Dark Grey, Light Grey, Black
⑤	Horizontal Adjustment Plate	POM	
⑥	Socket Cover	ABS	
⑦	Base Plate Cover		

RoHS	CAD	Item Code	Item Name	Colour	Door Width	Door Height	Door Thickness	Door Weight kgf/2 pcs	Door Weight kgf/3 pcs	Opening Angle
●	●	170-053-252	HES2S-140-A125-DGR	Dark Grey	Max. 900	Max. 2700	Min. 38	50	65	125°
●	●	170-053-253	HES2S-140-A125-LGR	Light Grey						
●	●	170-050-758	HES2S-140-A125-BL	Black						